

Project: _____ Type: _____
 Drawn by: _____ Catalogue #: _____ Date: _____

Individual Spec Sheet

PTR

LED ROUND POST TOP

3 CCT AND 3 POWER SELECTABLE

INTEGRATED 7 PIN RECEPTACLE AND SHORTING CAP

ORDERING INFORMATION

Order Code: 69662
Model Number: PTRPS755Q3CBKPR7
UPC: 069549028814
Case Quantity: 1
DLC Unique ID: S-VJCL32

PHYSICAL DATA

Finish: Black
Housing Material: Die-cast aluminum
Mounting: The post top arm accommodates 2-3/8" and 3" tenons

PERFORMANCE DATA

Watts (W): 50/60/75
Volts (V AC): 120-347
Color Temperature (K):¹ 3 000/4 000/5 000
Lumen Output (lm):² 6 750/8 100/10 125
Efficacy (lm/W): 135
CRI: 80+
Life L70 (h):³ 50 000
Dimming: 0-10 V
Photocell (Yes/No): No
EPA (ft²): 2.31
Power Factor: 0.90
Distribution Light Type: Type V
Frequency (Hz): 50/60
Surge Protection (kV): 6
Input Current (A): 0.29
Operating Temp. Range: -40 °C to 45 °C (-40 °F to 113 °F)

¹ Typical color temperature range: +/- 5 %.

² Lumen values are derived from photometric testing. Initial lumens range: +/- 10 %.

³ Life hours are derived from IESNA LM-80 testing report and projected per IESNA TM-21 extrapolations.

LUMEN SPECIFICATION TABLE

| Watts (W) | 3 000 K | | 4 000 K | | 5 000 K | |
|--------------|-------------------|-----------------|-------------------|-----------------|-------------------|-----------------|
| | Lumen output (lm) | Efficacy (lm/W) | Lumen output (lm) | Efficacy (lm/W) | Lumen output (lm) | Efficacy (lm/W) |
| 50 | 7 220 | 144 | 7 770 | 155 | 7 738 | 155 |
| 60 | 8 489 | 141 | 9 209 | 153 | 9 128 | 152 |
| 75 | 10 066 | 134 | 11 518 | 154 | 11 548 | 154 |

DEFAULT PROGRAMMING

75 W / 4 000 K

This lighting equipment complies with Canadian standard ICES-005 issue 5 class A for use in commercial applications / class B for use in residential applications. Data is based upon tests performed in a controlled environment.

Actual performance can vary depending on operating conditions. Specifications are subject to change without notice.



Slipfitter mounting
(sold separately)



Square/Round pole mounting
(sold separately)



IK08



Not all products are qualified on the DLC QPL. To view our DLC qualified products, please consult the DLC Qualified Products List at www.designlights.org/search.

¹ When the luminaire is set at 3 000 K operation. Only model 69662 must be ordered for IDA certification compliance.

ACCESSORIES (order separately)

| Order code | Type |
|------------|----------------------------|
| 69664 | Slipfitter |
| 69665 | Square/Round pole arm |
| 70271 | 3-Pin twist lock photocell |
| 70272 | 7-Pin twist lock photocell |



Slipfitter



Square/Round Pole arm



3-Pin twist lock photocell



7-Pin twist lock photocell

COMPATIBLE DIMMERS¹

| Brand | Model |
|---------|--------------------------|
| Leviton | DS710, IP710 |
| Lutron | NTSTV-DV, DVSTV, DDTV-WH |
| Legrand | RH4FBL3PW |

Dimming range: 0%-100%

¹ This table shows dimmers that have been tested and have demonstrated proper operation under normal conditions. Each installation being unique, various factors such as load, common neutrals or other electrical products on the circuit can, in certain instances, cause variance in system performance. Read and comply to the dimmer installation instructions. Consult dimming system manufacturer for additional support in operation. Some dimmers may require more than one product for stable operation. Stanpro recommends to use dimmers designed to work with LED products. Older dimmers designed for incandescent products may cause erratic operation.

DRILLING PATTERN

69665

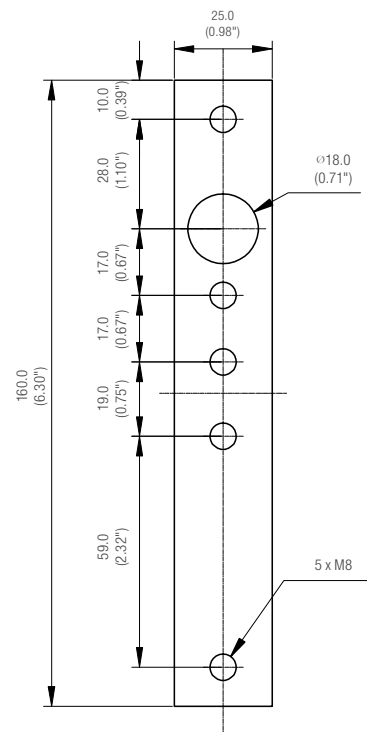

DIMENSIONS AND WEIGHTS

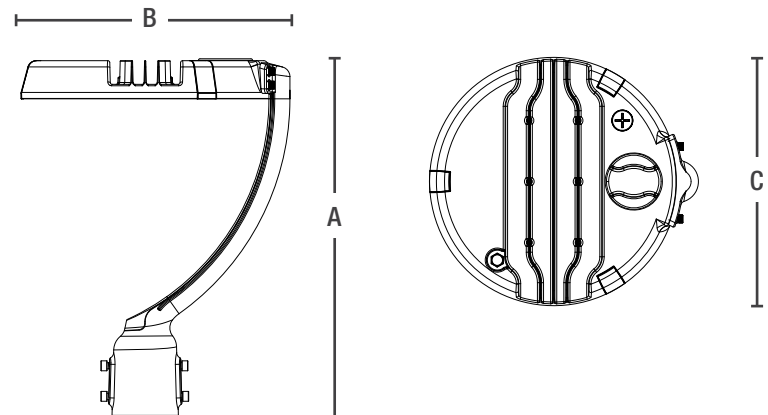

| | 75 W, 150 W |
|------------------|------------------|
| A in. (cm) | 18.31" (46.5 cm) |
| B in. (cm) | 13.9" (35.3 cm) |
| C in. (cm) | 12.8" (32.5 cm) |
| Net weight (lbs) | 9.46 |

Data is based upon tests performed in a controlled environment. Actual performance can vary depending on operating conditions. All products are subject to change or may be discontinued any time without notice.

PHOTOMETRIC DATA¹

69662 • PTRPS755Q3CBKPR7 • 75 W • 4 000 K • 11 518 lm

Polar candela distribution

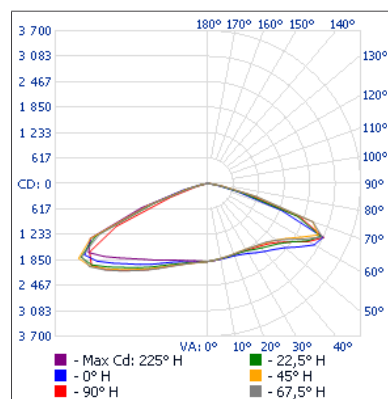

Zonal lumen summary

| Zone | Lumens | % Fixture |
|--------|----------|-----------|
| 0-30 | 1 658.7 | 14.4 |
| 0-40 | 3 047.8 | 26.5 |
| 0-60 | 7 616.7 | 66.1 |
| 60-90 | 3 810.1 | 33.1 |
| 70-100 | 1 060.3 | 9.2 |
| 90-120 | 35.7 | 0.3 |
| 0-90 | 11 426.9 | 99.2 |
| 90-180 | 91.6 | 0.8 |
| 0-180 | 11 518.4 | 100 |

Illuminance at a distance

| Center beam fc | | Beam width | |
|----------------|------|------------|--------|
| 17.0' | 6.53 | 68.8' | 58.1' |
| 34.0' | 1.63 | 137.6' | 116.3' |
| 51.0' | 0.73 | 206.4' | 174.4' |
| 68.0' | 0.41 | 275.2' | 232.5' |
| 85.0' | 0.26 | 344' | 290.7' |
| 102.0' | 0.18 | 412' | 348.8' |

■ Vert. spread: 127.4°
■ Horiz. spread: 119.4°

¹ Complete IES files available on our website.

| Qty | Description | Price |
|-----|-------------|-------|
| | | |

I accept the specifications of the luminaire configuration mentioned above.

Name: _____

Company: _____

Signature: _____

Date: _____

Data is based upon tests performed in a controlled environment. Actual performance can vary depending on operating conditions.
 All products are subject to change or may be discontinued any time without notice.