

Project: _____ Type: _____
 Drawn by: _____ Catalogue #: _____ Date: _____

Individual Spec Sheet

24 V LED DRIVER

5-IN-1 DIMMABLE HARDWIRE

High Power | Class 2

ORDERING INFORMATION

Order Code: 69132
Model Number: LED/DRIVER/192W/24V/HW/D
 KVE-C24192-TMWJ1-BA
UPC: 069549024809
Case Quantity: 10

PHYSICAL DATA

Dimensions: 9 1/8 x 4 5/8 x 1 5/8 in. (23.2 x 11.6 x 4.0 cm)
Type: Hardwire Driver - Dimmable
Color: Black

PERFORMANCE DATA

Output Power (W): 192 (2 x 96 W)
Input Voltage (V AC): 120-277
Output Voltage (V DC): 24
Input Current (mA): 2 200
Output Current (mA): 8 000
Frequency (Hz): 47/63
Power Factor: ≥0.95
Operating Temperature: -40 °C to 60 °C (-40 °F to 140 °F)
Dimming Type: Forward and Reverse (TRIAC / ELV / MLV, 0-10 V, 1-10 V, Potentiometer, 10 V PWM).
Dimming Range: 0 % - 100 %

DIMENSIONS

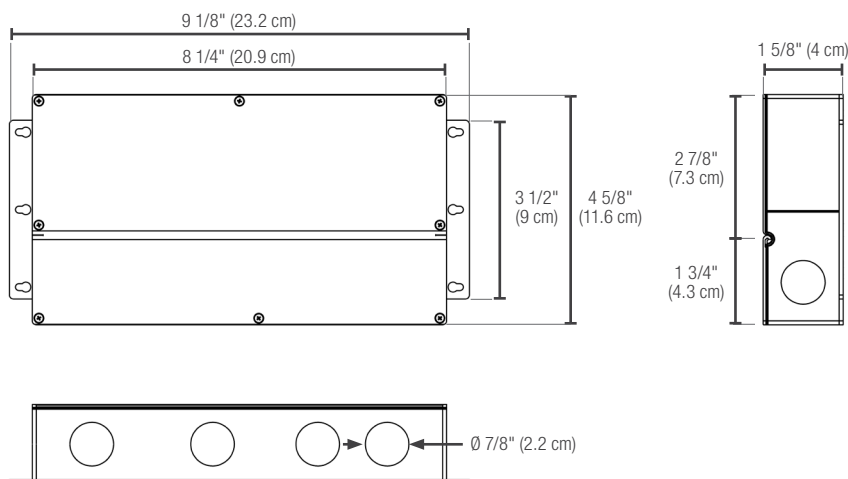

5 yrs
 warranty

dimmmable

66
 wet
 location

constant
 volts

CLASS
2
 compliant

CERTIFIED

RoHS

Data is based upon tests performed in a controlled environment. Actual performance can vary depending on operating conditions.
 All products are subject to change or may be discontinued any time without notice.

COMPATIBLE DIMMERS¹
0-10 V DIMMING

Brand	Model number	Dimming Range
Lutron	DVSTV-WH	4.5 - 100 %
	DVTV-WH	8 - 100 %

TRIAC DIMMING

Brand	Model number	Dimming Range	Volts (V AC)
Lutron	SCL-153PR-WH, DVCL-153PR-WH, DVWCL-153PH-LA, CTCL-153PDH-LA, TGCL-153PR-WH, TGCL-153PH-WH, CT-600PR-IV, CT-600PR-WH, CT-103PR-WH, DV-600PR-BL, DV-600PR-WH, TG-600PR-LA, TG-600PR-IV, TG-600PR-WH, TG-10PR-WH, S-600PR-WH, MRF2-6ND-120-AL, MSCELV-600M, MEF2-6ELV-120	0 - 100 %	100-130 V
	MACL-153MH-LA, MIR-600M, MRF2-6CL-GR, PD-6WCL, SELV-300P, DVELV-300P	1-100 %	100-130 V
	DZ6HD	3-100 %	100-130 V
	NTLV-600-277-WH, NTF-10-277	0 - 100 %	277 V
	ST-12P-277	3-100 %	277 V
Leviton	IPL06, 6602, 6683, AWSMT-EAW, AWSMT-EAW	0-100 %	120 V
	VPI06-1LZ, TT106-1LZ, DZ6HD, 6674, 6672, TBL03	1-100 %	120 V
Legrand	WSCL450TCCCV4, LSCL453PLACCV4	0-100 %	120 V
	RHCL453PNICCV6	1-100 %	120 V
Crestron	CLW-DELVE-P-W-S	0-100 %	120 V

¹ This table shows dimmers that have been tested and have demonstrated proper operation under normal conditions. Each installation being unique, various factors such as load, common neutrals or other electrical products on the circuit can, in certain instances, cause variance in system performance. Read and comply to the dimmer installation instructions. Consult dimming system manufacturer for additional support in operation. Some dimmers may require more than one product for stable operation. Stanpro recommends to use dimmers designed to work with LED products. Older dimmers designed for incandescent products may cause erratic operation.

Qty	Description	Price

I accept the specifications of the luminaire configuration mentioned above.

Name: _____

Company: _____

Signature: _____

Date: _____

Data is based upon tests performed in a controlled environment. Actual performance can vary depending on operating conditions.
All products are subject to change or may be discontinued any time without notice.