

Project: \_\_\_\_\_ Type: \_\_\_\_\_  
 Drawn by: \_\_\_\_\_ Catalogue #: \_\_\_\_\_ Date: \_\_\_\_\_

## Individual Spec Sheet

# 24 V LED DRIVER

## 5-IN-1 DIMMABLE HARDWIRE

### High Power | Class 2

### ORDERING INFORMATION

**Order Code:** 69133  
**Model Number:** LED/DRIVER/288W/24V/HW/D  
 KVE-C24288-TMWJ1-BA  
**UPC:** 069549024816  
**Case Quantity:** 10

### PHYSICAL DATA

**Dimensions:** 10.83 x 4.57 x 1.57 in. (275 x 116 x 40 mm)  
**Type:** Hardwire Driver - Dimmable  
**Color:** Black

### PERFORMANCE DATA

**Output Power (W):** 288 (3 x 96 W)  
**Input Voltage (V AC):** 120-277  
**Output Voltage (V DC):** 24  
**Input Current (mA):** 3 100  
**Output Current (mA):** 12 000  
**Frequency (Hz):** 47/63  
**Power Factor:** ≥0.95  
**Operating Temperature:** -40 °C to 60 °C (-40 °F to 140 °F)  
**Dimming Type:** Forward and Reverse (TRIAC / ELV / MLV, 0-10 V, 1-10 V, Potentiometer, 10 V PWM).  
**Dimming Range:** 0 % - 100 %

### DIMENSIONS

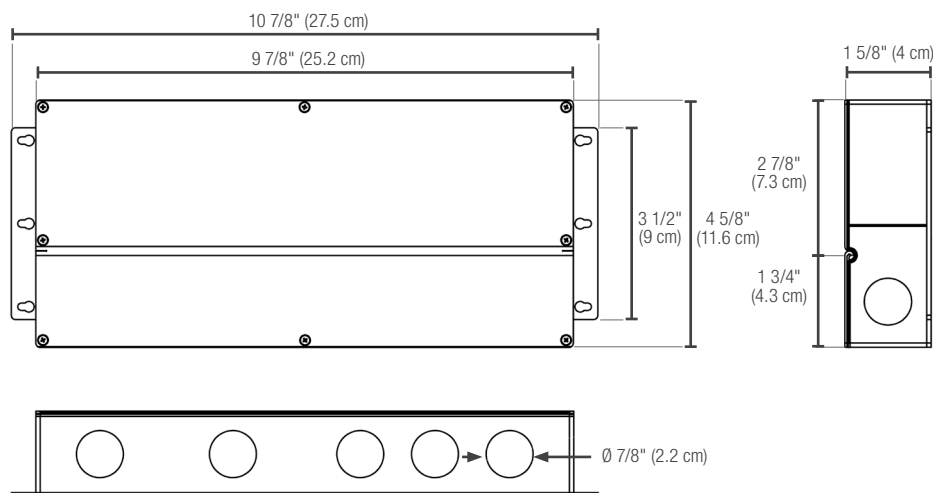

**5** yrs  
warranty

dimmmable

60°  
wet  
location

constant  
volts

CLASS  
2  
compliant

CERTIFIED

RoHS

Data is based upon tests performed in a controlled environment. Actual performance can vary depending on operating conditions.  
 All products are subject to change or may be discontinued any time without notice.

**COMPATIBLE DIMMERS<sup>1</sup>**
**0-10 V DIMMING**

| Brand  | Model number | Dimming Range |
|--------|--------------|---------------|
| Lutron | DVSTV-WH     | 4.5 - 100 %   |
|        | DVTV-WH      | 8 - 100 %     |

**TRIAC DIMMING**

| Brand    | Model number   | Dimming Range | Volts (V AC) |
|----------|--|---------------|--------------|
| Lutron   | SCL-153PR-WH, DVCL-153PR-WH, DVWCL-153PH-LA, CTCL-153PDH-LA, TGCL-153PR-WH, TGCL-153PH-WH, CT-600PR-IV, CT-600PR-WH, CT-103PR-WH, DV-600PR-BL, DV-600PR-WH, TG-600PR-LA, TG-600PR-IV, TG-600PR-WH, TG-10PR-WH, S-600PR-WH, MRF2-6ND-120-AL, MSCELV-600M, MEF2-6ELV-120 | 0 - 100 %     | 100-130 V    |
|          | MACL-153MH-LA, MIR-600M, MRF2-6CL-GR, PD-6WCL, SELV-300P, DVELV-300P   | 1-100 %       | 100-130 V    |
|          | DZ6HD  | 3-100 %       | 100-130 V    |
|          | NTLV-600-277-WH, NTF-10-277  | 0 - 100 %     | 277 V        |
|          | ST-12P-277   | 3-100 %       | 277 V        |
| Leviton  | IPL06, 6602, 6683, AWSMT-EAW, AWSMT-EAW  | 0-100 %       | 120 V        |
|          | VPI06-1LZ, TT106-1LZ, DZ6HD, 6674, 6672, TBL03   | 1-100 %       | 120 V        |
| Legrand  | WSCL450TCCCV4, LSCL453PLACCV4  | 0-100 %       | 120 V        |
|          | RHCL453PNICCV6   | 1-100 %       | 120 V        |
| Crestron | CLW-DELVE-P-W-S  | 0-100 %       | 120 V        |

<sup>1</sup> This table shows dimmers that have been tested and have demonstrated proper operation under normal conditions. Each installation being unique, various factors such as load, common neutrals or other electrical products on the circuit can, in certain instances, cause variance in system performance. Read and comply to the dimmer installation instructions. Consult dimming system manufacturer for additional support in operation. Some dimmers may require more than one product for stable operation. Stanpro recommends to use dimmers designed to work with LED products. Older dimmers designed for incandescent products may cause erratic operation.

| Qty | Description | Price |
|-----|-------------|-------|
|     |             |       |

I accept the specifications of the luminaire configuration mentioned above.

Name: \_\_\_\_\_

Company: \_\_\_\_\_

Signature: \_\_\_\_\_

Date: \_\_\_\_\_

Data is based upon tests performed in a controlled environment. Actual performance can vary depending on operating conditions.  
All products are subject to change or may be discontinued any time without notice.