

## ORDERING INFORMATION

Order code: 58984  
Description: FC6T9/CW/RS/4P/STD  
UPC: 69549589841  
Case quantity: 12



Nominal diameter : 7 in. (165 mm) Dia. : 1 3/16 in. (30 mm)

## PERFORMANCE DATA

Shape: T9  
Base: G10q-4  
Starting method: Rapid Start (RS)  
Wattage (W): 20  
Colour temperature (K): 4 100  
CRI: 82  
Rated life on IS<sup>1</sup> ballast:  
Based on a 3 hour start 10 000  
Initial lumens (lm): 890  
Mean lumens (lm): 850  
Nominal efficiency (lm/W): 45  
TCLP compliant: Yes  
Phosphor composition: Triphosphor  
Nominal lamp operating frequency (Hz): 60  
<sup>2</sup> Minimum starting temperature (°C): -10

## DIMENSIONS

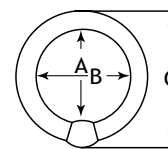

A Max	B Min / Max	C Max
Inner diameter from base to tube	Inner diameter from tube to tube	Outer overall diameter from base to tube
4.23 in. 107.5 mm	3.99 in./ 4.23 in. 101.5 mm/ 107.5 mm	6.50 in./ 165.8 mm

## SPECTRAL DISTRIBUTION

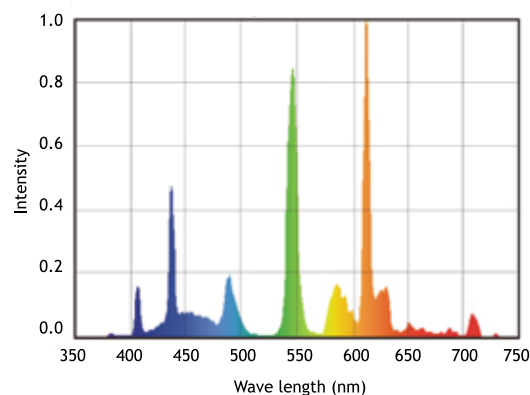

<sup>1</sup> The life rating indicated is based on 3 hour burning cycles under specified conditions and with ballast meeting ANSI specifications.

<sup>2</sup> The minimum starting temperature is a function of the ballast. The minimum starting temperature is based on a STANDARD brand T9 Circline ballast.

